

THE ART INSTITUTE OF CHICAGO
CATALOGUE OF THE
SEVENTH ANNUAL 8th
EXHIBITION OF

WATER-COLORS, PASTELS
AND MINIATURES
BY AMERICAN ARTISTS

APRIL 16
TO JUNE 7

1896

PRINTED FOR THE
ART INSTITUTE
CHICAGO, 1896



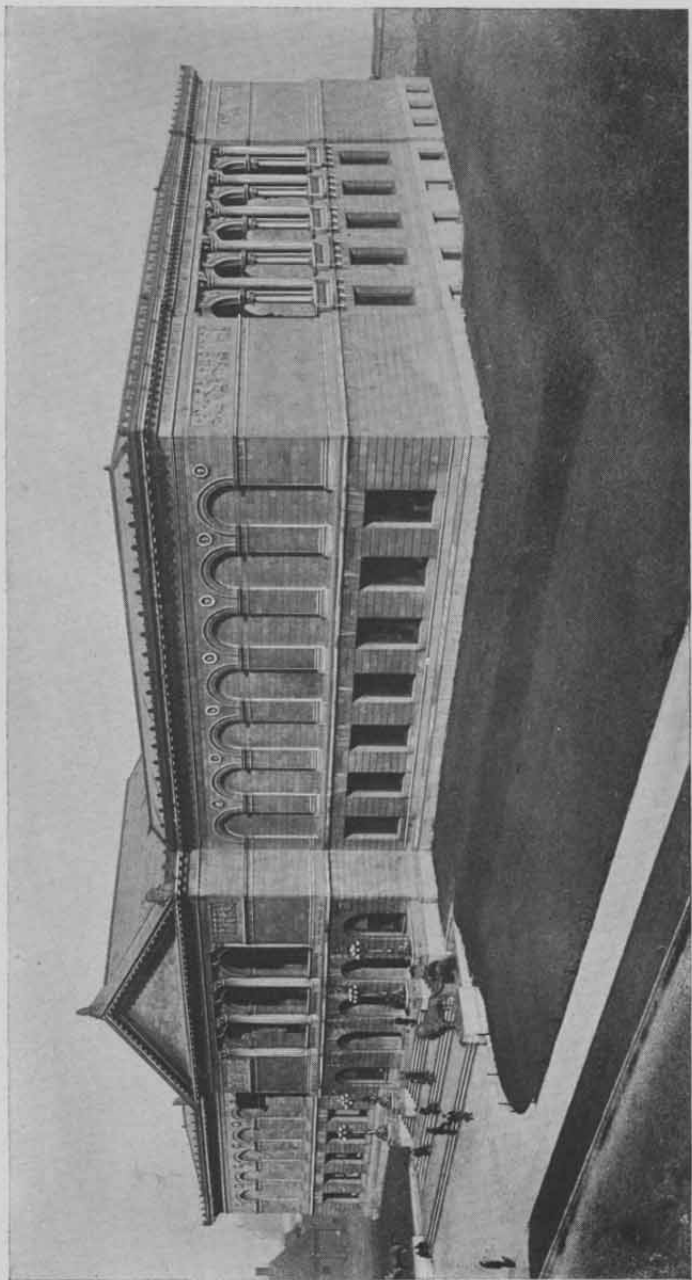

THE ART INSTITUTE,
Lake Front, opposite Adams Street, Chicago.

THE ART INSTITUTE OF CHICAGO

CATALOGUE OF THE
SEVENTH ANNUAL
EXHIBITION OF

WATER-COLORS, PASTELS
AND MINIATURES
BY AMERICAN ARTISTS

APRIL 16
TO JUNE 7

1896

PRINTED FOR THE
ART INSTITUTE
CHICAGO, 1896



TRUSTEES OF THE ART INSTITUTE OF CHICAGO.

1895-96.

CHARLES L. HUTCHINSON,	WILLIAM T. BAKER,
EDWARD E. AYER,	NATHANIEL K. FAIRBANK,
JAMES H. DOLE,	ALBERT A. SPRAGUE,
JOHN C. BLACK,	ADOLPHUS C. BARTLETT,
JOHN J. GLESSNER,	CHARLES D. HAMILL,
EDSON KEITH,	TURLINGTON W. HARVEY,
ALLISON V. ARMOUR,	HOMER N. HIBBARD,
MARSHALL FIELD,	HENRY H. GETTY,
R. HALL McCORMICK,	BRYAN LATHROP,
SAMUEL M. NICKERSON,	ROBERT A. WALLER,
MARTIN A. RYERSON,	O. D. WETHERELL, Comptroller,
GEO. B. SWIFT, Mayor (<i>Ex Officio</i>).	(<i>Ex Officio</i>).

OFFICERS

CHARLES L. HUTCHINSON,	JAMES H. DOLE,
<i>President.</i>	<i>Vice-President.</i>
LYMAN J. GAGE,	N. H. CARPENTER,
<i>Treasurer.</i>	<i>Secretary.</i>
WILLIAM M. R. FRENCH,	
<i>Director.</i>	

EXECUTIVE COMMITTEE

CHARLES L. HUTCHINSON.	CHARLES D. HAMILL,
JAMES H. DOLE,	JOHN C. BLACK,
ALBERT A. SPRAGUE,	MARTIN A. RYERSON,
WILLIAM T. BAKER,	

ART COMMITTEE

CHARLES L. HUTCHINSON,	JAMES H. DOLE,
MARTIN A. RYERSON,	BRYAN LATHROP,
ROBERT A. WALLER,	

THE ART INSTITUTE OF CHICAGO was incorporated May 24, 1879, for the "founding and maintenance of schools of art and design, the formation and exhibition of collections of objects of art, and the cultivation and extension of the arts of design by any appropriate means." The Museum building upon the Lake Front, first occupied in 1893, is open to the public every week day from 9 to 5, and Sundays from 1 to 5. Admission is free to members and their families at all times, and free to all upon Wednesdays, Saturdays and Sundays.

The Art School, in the same building, includes departments of Drawing, Painting, Sculpture, Decorative Designing and Architecture.

All friends of the Art Institute are invited to become members. Annual Members pay a fee of ten dollars for the year. Governing Members pay twenty-five dollars a year, and an initiation fee of one hundred dollars. The number of Governing Members is restricted to two hundred and fifty. All members are entitled, with their families and visiting friends, to admission to all exhibitions, receptions, public lectures and entertainments of the Institute, and to the use of the reference library upon art.

DESIGNATION OF GALLERIES.

MAIN FLOOR.

SEE PLAN.

ROOM 1,	-	Elbridge G. Hall Collection of Sculpture.
		Egyptian and Assyrian.
ROOM 2, (Corridor)		Same: Asia Minor, and Early Greek.
ROOM 3,	- - - -	Same: Age of Pheidias.
ROOM 4,	- - - -	Same: Later Greek.
ROOM 5,	- - - -	Same: Roman.
ROOM 6, (Corridor)	- - -	Same: Renaissance.
ROOM 7,	- - - -	Office of the Director.
ROOM 8, (Hall)	-	Elbridge G. Hall Collection: Modern.
ROOM 9,	- - - -	Office of the Secretary.
ROOM 10,	- -	Elbridge G. Hall Collection: Modern.
ROOM 11, (Corridor)	-	Historical Collection of French Sculpture and Architecture.
ROOM 12,	- - - -	Same.
ROOM 13, (Corridor)	- - - -	Same.
ROOM 14,	- - -	Temporary Lecture Room.
ROOM 15,	-	Library, and Mrs. D. K. Pearsons Collection of Braun Photographs.
ROOMS 16 to 24 are in the part not yet built.		

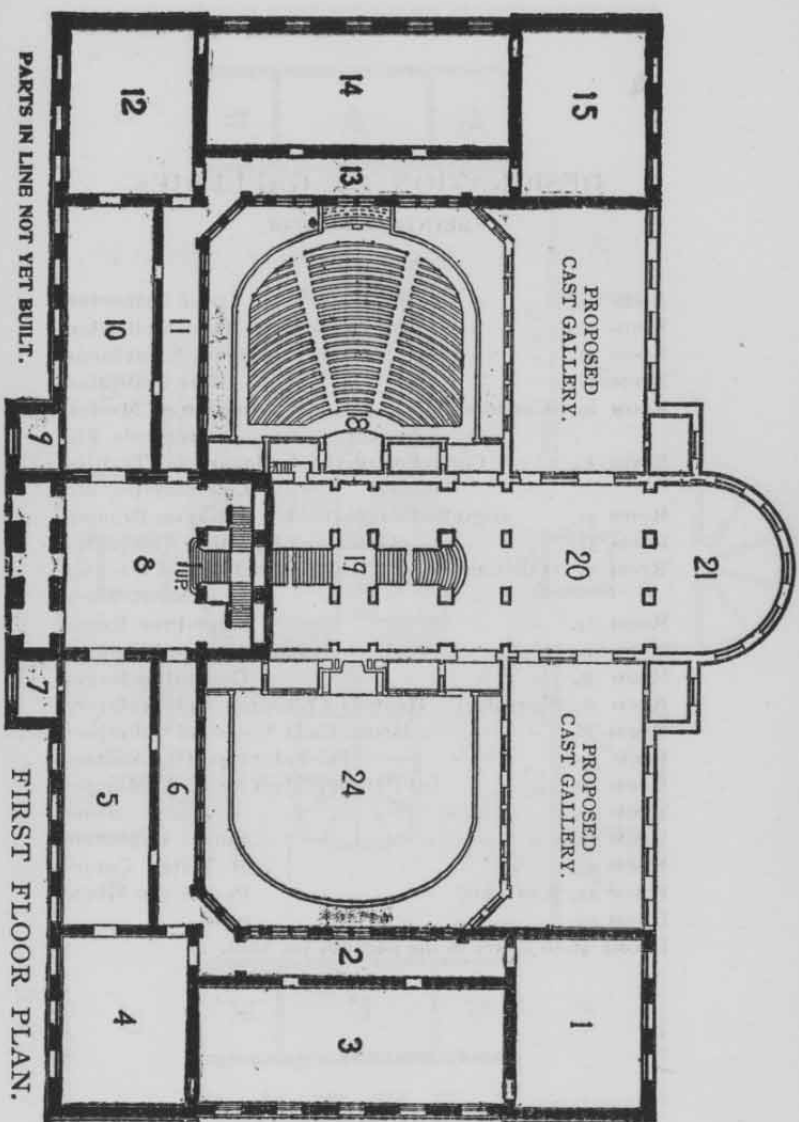

DESIGNATION OF GALLERIES.

SECOND FLOOR.

SEE PLAN.

Room 25,	-	-	-	-	-	-	-	Doré Collection.
Room 26,	-	-	-	-	-	-	-	Doré Collection.
Room 27,	-	-	-	-	-	-	-	Temporary Exhibitions.
Room 28,	-	-	-	-	-	-	-	Doré Collection.
Room 29, (Corridor)	-	-	-	-	-	-	-	Getty Collection of Musical Instruments, Etc.
Room 30,	-	-	-	-	-	-	-	Collection of the Antiquarians: Textiles, Embroideries, Etc.
Room 31,	-	-	-	-	-	-	-	Higinbotham Collection of Naples Bronzes.
Room 32,	-	-	-	-	-	-	-	Greek and Egyptian Antiquities.
Room 33, (Corridor)	-	-	-	-	-	-	-	Ryerson-Hutchinson Collection of Metal Work.
Room 34,	-	-	-	-	-	-	-	Committee Room.
Room 35, (Hall)	-	-	-	-	-	-	-	Sculpture and Paintings.
Room 36,	-	-	-	-	-	-	-	Committee Room.
Room 37, (Corridor)	-	-	-	-	-	-	-	Hanford Collection and Sculpture.
Room 38,	-	-	-	-	-	-	-	Henry Field Memorial Collection.
Room 39,	-	-	-	-	-	-	-	Oil Paintings, Old Masters.
Room 40,	-	-	-	-	-	-	-	Oil Paintings, lent by A. A. Munger.
Room 41,	-	-	-	-	-	-	-	Same.
Room 42,	-	-	-	-	-	-	-	Annual Exhibition of Water Colors, Pastels and Miniatures.
Room 43,	-	-	-	-	-	-	-	
Room 44, (Corridor)	-	-	-	-	-	-	-	
Room 45,	-	-	-	-	-	-	-	
Rooms 46 to 53 are in the part not yet built.								

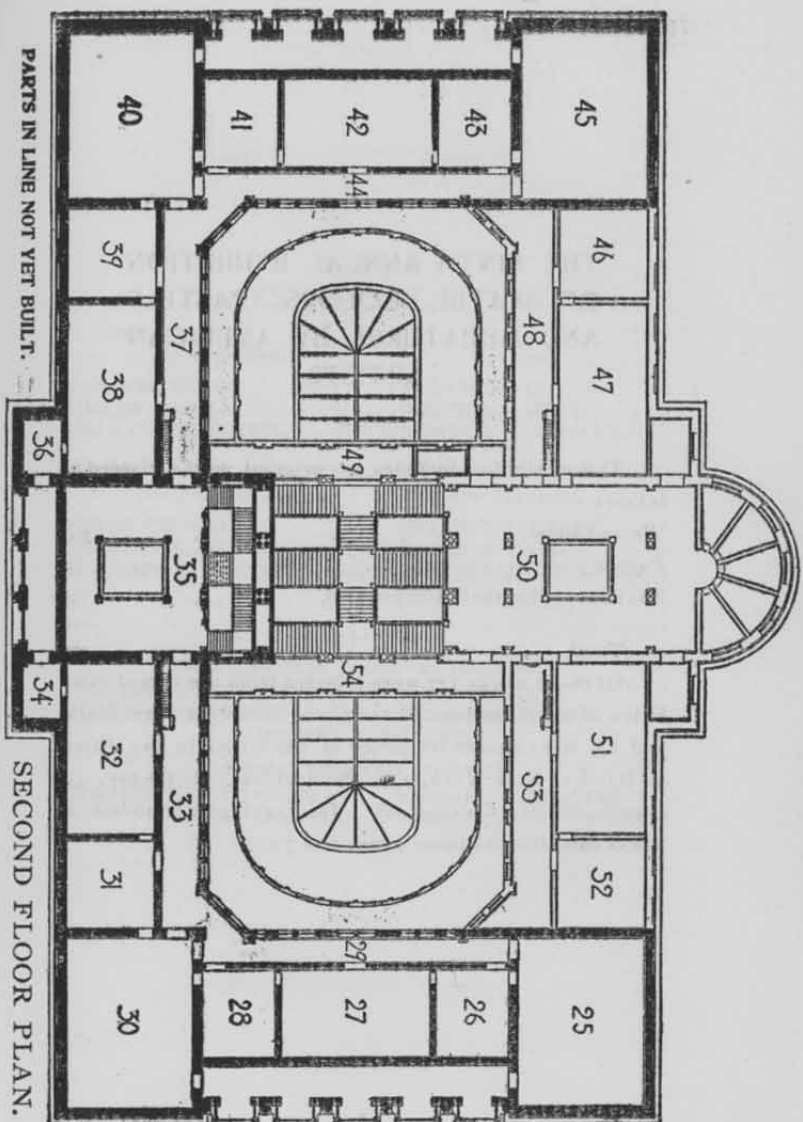

THE NINTH ANNUAL EXHIBITION OF WATER COLORS, PASTELS AND MINIATURES, BY AMERICAN ARTISTS.

This exhibition includes 476 original works, classed as follows:

Water Colors,	355
Pastels,	82
Miniatures (numbered in groups),	39
Total,	476

Of these works 127 were selected from the recent exhibition of the American Water Color Society in New York, and 349 were chosen by juries of the artists in five cities, as follows: New York, 137; Philadelphia, 58; Boston, 55; Cincinnati, 31; Chicago 66. The aggregate number of works submitted to these juries was 750.

JURIES OF SELECTION.

For New York.

C. HARRY EATON,
CHILDE HASSAM,
FERNAND LUNGREN.

For Boston.

ROSS TURNER,
WALTER L. DEAN,
EDWARD H. BARNARD.

For Philadelphia.

HENRY THOURON,
CHARLES E. DANA,
CLIFFORD P. GRAYSON.

For Cincinnati.

FRANK DUVEINECK,
HENRY F. FARNY,
JOHN WARD DUNSMORE.

For Chicago.

ART COMMITTEE OF THE ART INSTITUTE.

CHARLES L. HUTCHINSON,	JAMES H. DOLE,
MARTIN A. RYERSON,	BRYAN LATHROP,
ROBERT A. WALLER.	

ADVISORY COMMITTEE OF ARTISTS.

CHARLES E. BOUTWOOD,	RICHARD S. ROBBINS,
PAULINE A. DOHN.	

FOR INFORMATION REGARDING EXHIBITS FOR SALE APPLY TO MISS WILLARD, AT DESK IN ROOM XLV.

ALL PAYMENTS FOR EXHIBITS PURCHASED MUST BE MADE TO THE SECRETARY OF THE ART INSTITUTE.

CATALOGUE OF
THE NINTH ANNUAL EXHIBITION OF
WATER COLORS, PASTELS, AND
MINIATURES.
ART INSTITUTE OF CHICAGO.
1896.

ABBATT, AGNES DEAN—East Chester Road, Westchester, New York City. Pupil of Cooper Institute National Academy of Design, R. Swain Gifford, and James D. Smillie, New York. Member of American Water Color Society, New York.

1. Old homes on Sydney Harbor, Cape Breton.

AHRENS, ELLEN W. 1334 Chestnut st., Philadelphia.

2. Case of miniatures. Four portraits on ivory.

ANDREWS, CHARLES LOWELL—35 Oliver st., Boston.

3. Nova Scotia Shore. Pastel.

ANSHUTZ, THOMAS P.—201 S. 10th st., Philadelphia.

4. Old boatmen.
5. Seaboard pastures.
6. On the sand hills.
7. A farewell.
8. A crab fight.
9. Fishermen.
10. A sketch.

ASCENZO, MYRTLE GOODWIN D'—1020 Chestnut st., Philadelphia, Room 36. Born in North Sunbridge, Vermont. 1867. Pupil of Pennsylvania Museum School of Industrial Art, Philadelphia. Studied also in Rome and Venice.

11. Up for repairs, Venice.

AULT, CHARLES HENRY—1285 Cedar av., Cleveland, Ohio.

12. New Orleans Harbor.

AUS, CAROL—Studio Building, State and Ontario sts., Room 32. Born in Norway.

13. Five miniature portraits. On ivory.
 1. Mrs. Charles Harwood. Lent by Mrs. J. W. L. Slavens.
 2. Helen Sheridan.
 3. Child.
 4. Mrs. Hanna Aus.
 5. Henrietta Fredericks. Lent by Mrs. B. W. Fredericks.

BANCROFT, MRS. LENA T.—Grundmann Studios, Boston.

14. Button chrysanthemums.
 15. A New England sailor.

BARNARD, EDWARD H.—23 Irvington st., Boston. Born in Belmont, Massachusetts, 1855. Pupil of John B. Johnston, Museum of Fine Arts, Boston, and Boulanger, Lefebvre and R. Collin, Paris. Member of Boston Art Club. Bronze medals of Massachusetts Charitable Mechanic Association 1890 (portrait), 1892 (landscape). Jordan Prize, Boston, 1894.

16. An old peasant.

BARSE, GEORGE R., JR.—139 W. 55th st., New York. Born in Detroit, 1861. Pupil of Cabanel, Boulanger and Lefebvre, Paris. Member of Society of American Artists, New York. Instructor in Art Students' League, New York. First Prize, National Academy of Design, New York, 1895.

17. Bubbles.
 18. Slave at the altar.

BECK, OTTO WALTER—Art Academy, Cincinnati. Born in Dayton, Ohio. Studied in Munich. Instructor in Art Academy of Cincinnati.

19. Afterglow. Pastel.

BERNEKER, LOUIS FREDERICK — 1820 Locust st., St. Louis. Pupil of St. Louis School of Fine Arts. Member of St. Louis Society of Painters and Sculptors.

20. Dollie. Pastel.

BICKNELL, E. M.—35 N. 14th st., New York.

21. An old time whaler.

BIRNEY, WILLIAM VERPLANCK — The Sherwood, 58 W. 57th st., New York. Born in Ohio, 1858. Studied in Massachusetts Normal Art School, Boston, Pennsylvania Academy of the Fine Arts, Philadelphia, and in Munich and Paris. Honorable Mention, Munich.

22. The garden.

23. A little corner.

BLANEY, DWIGHT—12 St. Botolph st., Boston.

24. Coutances.

25. Piccadilly.

BLANKE, MARIE E. — 1734 Deming Court. Born in Chicago, 1875.

26. Jennie.

BONSALL, ELIZABETH F.—1334 Chestnut st., Philadelphia. Born in Philadelphia. Pupil of Pennsylvania Academy of the Fine Arts in Philadelphia, and of the Académie Colorossi, Raphael Collin, Girardot and Courtois in Paris. Mary Smith Prize and First Charles Toppan Prize, Pennsylvania Academy of the Fine Arts.

27. Coin du Luxembourg.

BRADLEY, SUSAN H.—1217 Spruce st., Philadelphia.

28. Shinnecock, Long Island.

BRECKENRIDGE, HUGH H.—10 S. 18th st., Philadelphia. Pupil of Pennsylvania Academy of the Fine Arts in Philadelphia, and of Bouguereau, Fernier and Doucet in Paris. Secretary of the Faculty and Instructor in the Pennsylvania Academy of the Fine Arts.

29. Tranquil waters. Pastel.

30. A summer sun. Pastel.

31. Plain of Barbizon, France. Pastel.

BRICHER, A. T.—2 W. 14th st., New York. Born in Portsmouth, New Hampshire, 1839. Self-taught. Member of American Water Color Society and Associate of National Academy of Design, New York.

32. Summer Sea, Monhegan, Maine.

BRIDGES, FIDELIA—Canaan, Connecticut. Born in Salem, Massachusetts. Pupil of William T. Richards. Member of American Water Color Society and Associate of National Academy of Design, New York.

33. Among apricot boughs.

34. A broad beach.

BROWN, CARROLL BUTLER—Van Dyck Studios, 939 Eighth av., New York.

35. A colonial porch.

36. An old fashioned garden.

37. A road through the forest—late October.

BROWN, JOHN APPLETON—253 W. 42d st., New York. Born in West Newbury, Massachusetts. Pupil of Émile Lambinet, Paris. Member of Society of American Artists and New York Water Color Club, New York. Medal at World's Columbian Exposition, Chicago, 1893.

38. Summer. Pastel.

39. Spring. Pastel.

BROWN, LILLIAN M.—6½ Vista Block, St. Louis.

40. Girl in doorway. Pastel.

41. Sunny corner. Pastel.

BROWNE, CHARLES FRANCIS—1733 Marquette Building, Chicago. Born in Natick, Massachusetts, 1859. Pupil of Pennsylvania Academy of the Fine Arts, Philadelphia, and Ecole des Beaux-Arts—Gérôme, Paris. Instructor in Art Institute.

42. A Moqui water carrier, Tusayan.

BRUENN, LEO—13 Piazza S. Pietro in Vincoli, Villino Splend, Rome. Born in Cincinnati, 1859. Studied in Munich Academy. Silver medals at Stuttgart and San Francisco, 1894.

43. Nearing life's end.

BUCKLIN, WILLIAM SAVERY—Red Bank, New Jersey. Born at the Phalanx, Red Bank. Pupil of Massachusetts Normal Art School, Boston, and of Art Students' League and Frederick Rondel, New York.

44. Philopena.

BUDWORTH, WILL S.—615 S. Eighth av., Mt. Vernon, New York. Born in Brooklyn, 1861.

45. The Shore, East Chester Creek.

46. End of October, Pelham Manor.

BUEHR, KARL ALBERT—302 Wabash av. Pupil of Art Institute.

47. Meditation.

BURBANK, ELBRIDGE AYER—700 Athenæum Building. Born in Harvard, Illinois, 1858. Pupil of the Art Institute, Chicago, and of Paul Nauen, Frederick Fehr and Toby Rosenthal in Munich. Yerkes First Prize 1892.

48. Has seen better days. Pastel.

BURGESS, MRS. RUTH PAYNE—323 W. 57th st., New York. Born in Montpelier, Vermont, 1865. Pupil of John J. Redmond, William J. Whittmore and Carroll Beckwith.

49. Fifty years ago.

50. A girl in white.

BURLEIGH, SYDNEY RICHMOND—at the Fleur-de-Lys, Thomas st., Providence, Rhode Island. Born in Little Compton, Rhode Island. Pupil of Jean-Paul Laurens, Paris.

51. By the old canal.

BUTLER, PHILIP A.—Auburndale, Massachusetts. Born in Amesbury, Massachusetts. Pupil of John McDougal, England. Member of Boston Art Club.

52. Old farm house near Sunapee Lake, New Hampshire.

CADY, HENRY NEWELL—5430 Morris st., Germantown, Philadelphia, Pennsylvania.

53. "Wave-worn outposts of the land."

54. Hurrying shoreward.

CASSADY, CORNELIA STUART—70 Pike Building, Cincinnati. Born in Cleves, Hamilton County, Ohio, 1872. Pupil of George Hopkins, Cincinnati, and of Prof. Louis Lutz and Prof. Thomas S. Noble in the Cincinnati Art Academy. Secretary of Cincinnati Woman's Art Club.

55. The twins. Miniature.

CAULDWELL, LESLIE—154 W. 57th st., New York. Pupil of Académie Julian (Boulanger and Lefebvre) and of Carolus-Duran, Paris.

56. A lazy little girl. Pastel.

57. A pair of brown eyes. Pastel.

58. La cigale. Pastel.

CHAPMAN, CARLTON T.—58 W. 57th st., New York. Born in New London, Ohio. Pupil of National Academy of Design and Art Students' League, New York, and of Académie Julian, Paris. Member of Society of American Artists, and of American Water Color Society, New York. Medal of World's Columbian Exposition Chicago, 1893. Silver Medal, Boston, 1892.

59. A stern chase is a long chase.
60. Engagement between the Wasp and the Frolic,
October 18, 1812.
61. A snug Harbor.

CLUSMANN, WILLIAM—446 S. Paulina st. Born in Laporte, Indiana. Pupil of Prof. Benzur at the Royal Academy, Munich. Member of Chicago Society of Artists. Honorable Mention, Stuttgart, Germany.

62. Wet day on the avenue.

COFFIN, WILLIAM A.—58 W. 57th st., New York. Born in Allegheny City, Pennsylvania, 1855. Pupil of Léon Bonnat, Paris. Member of Society of American Artists, New York Water Color Club and Architectural League, New York. Webb Prize, Society of American Artists, 1891. Second Hallgarten Prize, National Academy of Design, New York, 1886. First Vice-President of Municipal Art Society, New York. Picture, "The Rain," in permanent collection of Metropolitan Museum of Art, New York. Medal at Exposition Universelle, Paris, 1889. Exempt, Paris Salon.

63. Rear courtyard of Russell House, Broadway,
Worcester, England—residence of Frank
Millet.

COLE, GEORGE REULINGS—216 Thirty-third st., Chicago. Born in San Francisco, 1874.

64. Portrait of Mrs. J. G. McLoughlin. Miniature on ivory. Lent by Mrs. J. G. McLoughlin, New York.
65. Portrait of Miss Margaret Potter. Miniature on ivory. Lent by Mrs. O. W. Potter.
66. Portrait of Miss Gwendolen Mitchell. Miniature on ivory. Lent by Mrs. John J. Mitchell.

COLEMAN, BERTHA HELENA—Brockport, New York. Born in Brockport, 1865. Pupil of Syracuse University, Pratt Institute, Brooklyn. Herbert Adams, and Emma E. Lampert. Art Teacher in Brockport State Normal School.

67. An old doorway, North Holland.

COLMAN, SAMUEL—121 E. Thirty-ninth st., New York. Academician of National Academy of Design, New York.

68. Wayside market, Orizaba, Mexico.

69. The town and peak of Orizaba.

70. Environs of Windsor, England.

COMAN, MRS. CHARLOTTE B.—215 W. Eightieth st., New York. Born in Waterville, New York. Pupil of Harry Thompson and Emile Vernier, Paris. Bronze medal at California Midwinter Exposition, 1894.

71. A broken boundary.

72. A hillside in Upper Jay, New York.

CONANT, LUCY SCARBOROUGH—5 Park st., Boston. Born in Brooklyn, Connecticut, 1857. Pupil of Jean-Paul Laurens, Courtois, Le Roux and Lasar, in Paris.

73. The old garden.

74. In Normandy.

COOK, MISS JOSEPHINE M.—175 W. Fifty-eighth st., New York.

75. Still life.

COOKMAN, CHARLES EDWIN—146 W. 55th st., New York City. Born in Columbus, Ohio.

76. Marsh mallows.

77. In September.

COOPER, COLIN CAMPBELL—Art Club, Philadelphia. Born in Philadelphia. Instructor in Water Colors, Drexel Institute, Philadelphia.

IN HOLLAND.

- 78. Wool carder, Laren.
- 79. On the Merwede, evening.
- 80. Potato pickers, Laren.
- 81. Mill at Zwijndrecht.
- 82. The Maas at Dordrecht.

CRAIG, THOMAS B.—37 W. 22d st., New York. Born in Philadelphia. Pictures owned by Boston Art Club and Pennsylvania Academy of the Fine Arts.

- 83. In the month of May.

CRANE, BRUCE—Van Dyck Studios, 939 Eighth av., New York. Born in New York City, 1857. Member of Society of American Artists, American Water Color Society and New York Water Color Club, New York.

- 84. A winter morning.
- 85. Silence.

CURTIS, ALICE MARIAN—264 Boylston st., Boston. Born in Boston. Pupil of William M. Hunt, Ross Turner, C. H. Woodbury, Frank Duveneck.

- 86. A corner in an old New England pasture.
Pastel.
- 87. Low tide.

CUSHMAN, ALICE—1340 Walnut st., Philadelphia. Born in Philadelphia. Pupil of National Academy of Design, New York, and, in water colors, of Ross Turner.

- 88. From a marsh island.
- 89. The "Mindoro" in Salem Harbor.

DAINGERFIELD, ELLIOTT—145 W. 55th st., New York.

90. Fog clouds in the mountains.

DANA, CHARLES EDMUND—2013 DeLancey pl. Philadelphia. Studied in Pennsylvania Academy of the Fine Arts, Philadelphia; Atelier Luminals, Paris; and the Royal Academies of Dresden and Munich (architecture). Professor of Art in the University of Pennsylvania. Trustee of the Pennsylvania Museum and School of Industrial Art. Gold Medal of the Art Club of Philadelphia, 1891, etc.

91. El Bab (the gate) el Metouali, Cairo.

92. Abazzia S. Gregorio, Grand Canal, Venice.

DANA, EMMA LEWIS—Montpelier, Vermont. Born in West Lebanon, New Hampshire.

93. Still life.

D'ASCENZO. See Ascenzo.

DAWSON, ARTHUR—357 Grove av., Oak Park, Illinois. Born in England. Pupil of David Law and others in etching, of W. Maris in water colors, and of James Baker in oil painting. Studied also in the Art Department of South Kensington, London. Member of Royal Society of Painter-Etchers, City of London Artists' Society, Nineteenth Century Art Society, London, etc. Medal of the Science and Art Department, England.

94. The school girl.

DEAN, WALTER L.—19 Pemberton Square, Boston. Born in Lowell, Massachusetts. Pupil of Lefebvre and Boulanger, Paris. Painting purchased by Boston Art Club, 1887. Paintings purchased for Public Art and Library Building, Fitchburg and Ayer Library, Ayer, Massachusetts.

95. Toilers of the sea.

96. September evening, Cape Ann.

DECOMBES, EMILIE—16 Grundmann Studios, Clarendon st., Boston. Born in Paris, France. Pupil of Ross Turner, C. H. Woodbury and others.

97. Morning in the cove.

DERRICK, WILLIAM R.—504 Columbus av., New York. Born in San Francisco, 1858. Pupil of Bonnât, Boulanger and Lefebvre, Paris.

- 98. Sheep in landscape.
- 99. Home coming.
- 100. A Dorset beauty.

DILLAYE, BLANCHE—1301 Spruce st., Philadelphia. Born in Syracuse, New York. Pupil of Pennsylvania Academy of the Fine Arts, Philadelphia. Member of New York Water Color Club. Instructor of Art at Ogontz School, Pennsylvania. Chairman on Etchings for State of Pennsylvania on Woman's Auxiliary Committee, World's Columbian Exposition, Chicago, 1893.

- 101. Willows.
- 102. The cloud.
- 103. Field flowers.

DODGSHUN, MRS. A. VAN CLEEF—4441 Berkeley av. Born in Jersey City, New Jersey. Pupil of George H. Smillie, New York.

- 104. A quiet corner.
- 105. A sunny morning.

DOHN, PAULINE A.—9 Tree Studios, North State st. Born in Chicago. Pupil of the Art Institute, Chicago, the Pennsylvania Academy of the Fine Arts, Philadelphia, and the Académie Julian, Paris. First Yerkes Prize, Chicago, 1895.

- 106. A college song.

DOUGHERTY, PARKE C.—1430 S. Penn Square, Philadelphia. Pupil of Pennsylvania Academy of the Fine Arts.

- 107. A road through the sandhills. Pastel.

DOUGLAS, WALTER—835 Broadway, New York. Pupil of William M. Chase and National Academy of Design, New York.

- 108. Road to the sea.
- 109. A nymph.

DRAKE, WILLIAM HENRY—22 W. 9th st., New York. Born in New York City. Pupil of Doucet and Benjamin-Constant, Paris. Member of Salmagundi Club, American Water Color Society and New York Water Color Club, New York. Mention Honorable at Exposition Universelle, Paris, 1889.

- 110. Along shore, Bermuda.
- 111. Fisherman's home, Bermuda.
- 112. Somerset, Bermuda.

DUNSMORE, JOHN WARD—76 Pike Building, Cincinnati. Born in Riley, Butler County, Ohio, 1856. Pupil of Thomas Couture, Paris.

- 113. Case containing six miniatures on ivory.

EARLE, LAWRENCE C.—Montclair, New Jersey. Born in New York City, 1845. Studied in Munich, Florence and Rome. Member of American Water Color Society, New York, and New York Water Color Club.

- 114. The point.
- 115. Larry E.
- 116. Showery weather.

EATON, CHARLES WARREN—8 E. Twenty-third st., New York. Born in Albany, New York, 1857. Pupil of National Academy of Design and Art Students' League, New York. Member of American Water Color Society and New York Water Color Club, New York.

- 117. Midwinter.
- 118. Winter sunset.
- 119. Pathless snow.
- 120. Drear December.
- 121. The millpond.
- 122. A lonely hilltop.
- 123. The marsh. Pastel.

124. Autumnal. Pastel.
125. Gray and gold. Pastel.
126. Snowy slopes. Pastel.

EDMUNDSON, WILLIAM J.—143 Euclid av., Cleveland, Ohio. Born in Norwalk, Ohio, 1868. Pupil of R. W. Vonnoh Aman Jean and Jules Lefebvre. Instructor in Cleveland Art Club., Traveling Scholarship of the Pennsylvania Academy of the Fine Arts, 1893-94.

127. Portrait study of myself. Pastel.
128. October, near Grez, France. Pastel.

ELLIS, HARVEY—784 Powers building, Rochester, New York. Born in Rochester, 1852. Pupil of Edwin White.

129. The end. Pastel.

ELLS, ADA DANFORTH.

130. Bathers waiting for the tide.

EMMET, LYDIA FIELD—New Rochelle, New York. Born in New Rochelle, 1866. Pupil of William M. Chase, Siddons Mowbray, Kenyon Cox, Bouguereau and Robert Fleury.

131. Girl's head. Pastel.
132. Head. Pastel.

ENGLISH, F. F.—Claymont, Delaware. Born in New Albany, Indiana, 1855. Pupil of Pennsylvania Academy of the Fine Arts, Philadelphia.

133. The edge of the woods.

FARNY, HENRY FRANCIS—126 E. 4th st., Cincinnati. Member of National Jury of Selection and International Board of Awards, World's Columbian Exposition, Chicago, 1893. Medals from Paris Exposition Universelle, 1889, California Midwinter Exposition, 1894, and Atlanta Exposition, 1895.

134. The departure of the war party.

FARRER, HENRY—205 Sunnyside av., Brooklyn, New York. Born in London. Member of American Water Color Society, New York, and for ten years secretary of the same. President of New York Etching Club. Fellow of Royal Society of Painter-Etchers London.

135. "Twixt serious night and cheerful day."

136. The path to the ferry.

137. Sunset, West Virginia.

FAULKNER, HERBERT W.—139 W. 55th st., New York. Born in New York 1860. Pupil of R. Collin, Paris, and Carroll Beckwith, New York.

138. Evening in Venice.

FENN, HARRY—Montclair, New Jersey. Born in Richmond, Surrey, England. Member of American Water Color Society, New York. Medal at World's Columbian Exposition, Chicago, 1893.

139. A white day on a Maine island.

140. A silvery day on the Maine Coast.

FENNER, EMILY—South Orange, New Jersey. Born in New York 1850. Pupil of National Academy of Design and Cooper Institute, New York.

141. Double tulips.

FIELD, MRS. LOUISE BLODGETT—Knickerbocker Building, 178 Tremont st., Boston. Pupil of Ross Turner. Member of Ladies' Water Color Club, Boston, and Boston Art Students' Association.

142. Springtime.

FITLER, WILLIAM C.—12 E. 15th st., New York. Born in Philadelphia 1857. Pupil of Pennsylvania Academy of the Fine Arts.

143. A gray morning in April.

FORSYTH, W.—132 Fletcher av., Indianapolis.
Born in Hamilton County, Ohio. Pupil of Royal Academy, Munich.
Instructor Indiana School of Art. Medal, Munich, 1885.

144. Picking apples.

145. At eventide.

146. In October.

FOSTER, BEN—8 E. 23d st., New York. Born
in North Anson, Maine. Pupil of Art Students' League and Abbott H.
Thayer, in New York; and of Luc-Olivier Merson and Aimé Morot, in
Paris. Medal for Oils at World's Columbian Exposition, Chicago, 1893.
Second prize for water colors, Cleveland, 1895.

147. Downer's Glen, Manchester, Vermont.

148. Interior of a New England barn.

149. Autumn afternoon.

FRASER, JOHN A.—156 E. 92d st., New York.
Born in London. Pupil of the Royal Academy, and of Department of
Science, Marlboro House, London. Member of Royal Canadian Acad-
emy and of American Water Color Society, and New York Water Color
Club, New York. Represented in National Gallery, Canada, and in the
Royal Collection at Windsor Castle, England. Medaled in London, 1886,
and at World's Columbian Exposition, Chicago, 1893.

150. Springtime.

FREER, FREDERICK W.—Studio Building, State
and Ohio sts. Born in Chicago. Pupil of Royal Academy, Munich.
Teacher of Painting in Art Institute of Chicago. Associate of National
Academy of Design, New York. Pictures in Boston Art Club, Detroit
Club, etc. Medal of World's Columbian Exposition, Chicago, 1893.

151. Ethna. Pastel.

152. Just where he left them. Pastel.

GARRETSON, D.—8 E. 15th st. New York.

153. Winter.

GEST, JOSEPH HENRY—Grandin Road, E. W. H.,
Cincinnati. Born in Cincinnati, 1859.

154. Winter.

GILBERT, CHARLES ALLEN—132 E. 23d st., New York. Born in Hartford, Connecticut, 1873. Pupil of Art Students' League, New York, and of Académie Julian, Paris, under Benjamin-Constant and Jean-Paul Laurens.

- 155. Breton character.
- 156. The afternoon glow.
- 157. Breton boy.

GRANVILLE-SMITH, W.—52 E. 23d st., New York. Born in Granville, New York, 1871. Pupil of Art Students' League and W. Satterlee, New York.

- 158. Autumn leaves.
- 159. Au revoir.

GREEN, F. RUSSELL—145 W. 84th st., New York. Born in Chicago, 1859. Pupil of Académie Julian, Paris, under Boulangier, Lefebvre, Collin and Courtols. Member of American Water Color Society, New York Water Color Club and Salmagundi Club, New York.

- 160. A pastoral.
- 161. November day.

GREENLEAF, MARY WILLARD—11 Grundmann Studios, Boston.

- 162. Yellow roses.
- 163. On the marsh.

GRUPPE, CHARLES P.—824 Powers Building, Rochester, New York. Born in Pictou, Canada, 1860. Pupil of Josef Israels and Mesdag.

- 164. Sale of fish Scheveningen.
- 165. A road at Laren, Holland.

HALL, BEATRICE DAKYN—2013 Indiana av.

- 166. At Highland Park, Illinois.

HALLETT, HENDRICKS A.—42 Court st., Boston. Born in Charlestown, Massachusetts, 1847. Studied in the Antwerp Academy and in Paris. Member of Boston Art Club and Boston Water Color Society.

167. Arrival in winter.

168. A calm morning. Pastel.

HALLOWELL, MAY—264 Boylston st., Boston. Born in West Medford, Massachusetts. Studied in Museum of Fine Arts, Boston, and in Académie Julian, Paris. Member of Permanent Committee of School of Drawing and Painting, Museum of Fine Arts, Boston. Picture owned by Permanent Collection, Atlanta, Georgia.

169. Sketch. Pastel.

170. The little waif. Pastel.

HAM, ALICE—221 W. 57th st., New York. Born in Chicago 1872. Pupil of Art Institute, Chicago, Art Students' League. Rhoda Holmes Nicholls and William J. Whittemore, New York.

171. Violets.

HARDING, CHARLOTTE—1334 Chestnut st., Philadelphia. Born in Newark, New Jersey, 1873. Pupil of Pennsylvania Academy of the Fine Arts. Teacher in School of Design for Women, Philadelphia.

172. Yellow roses.

173. A color scheme.

HART, MARY E.—96 Fifth av., New York. Born in Durham, Connecticut. Pupil of Yale Art School, New Haven, Connecticut.

174. English violets.

175. A daisy field.

HARTSON, WALTER C.—365 Lenox av., New York. Born in Wyoming, Iowa, 1866.

176. Fading into night.

177. Windmills in the Lowlands.

HASSAM, CHILDE—152 W. 57th st., New York. Born in Boston, 1859. Member of Society of American Artists, American Water Color Society and New York Water Color Club, New York; and of the Munich "Secessionist" Society. Medals in Paris (1889), Munich (1892), Chicago (1893). First prize (\$300) of Cleveland Art Association, 1895. Webb prize of \$300, Society of American Artists, New York, 1895; second prize (\$1,500), Boston Art Club, 1896.

- 178. The blue Caribbean.
- 179. Gray morning.
- 180. Gloucester street.
- 181. Fifth avenue near the park—rainy day.

HATCH, LORENZO JAMES—226 Central Park West, New York City. Born in Hartford, Washington county, New York, 1857. Pupil of Art Students' League, Washington, D. C., and W. H. Holmes.

- 182. Reflections.
- 183. Baldwin's Hill.

HAUSHALTER, GEORGE M.—Medford, Massachusetts. Born in Portland, Maine. Pupil of Boulanger and Lefebvre and École des Beaux-Arts, Paris.

- 184. Night in Venice.
- 185. Italian interior.
- 186. Venetian child—study.

HAYDEN, CHARLES H.—23 Irvington st., Boston. Born in Plymouth, Massachusetts, 1856. Pupil of Boulanger, Le Fevre and R. Collin, Paris. Pictures owned by Boston Art Club and Museum of Fine Arts, Boston. Mention Honorable, Exposition Universelle, Paris, 1889. Jordan Prize (\$1,500), Boston, 1895.

- 187. Old mills, S. Yarmouth, Cape Cod.

HAYNES, CAROLINE COVENTRY—253 W. 42nd st., New York. Born in New York.

- 188. Listening to the birds. Pastel.
- 189. Still life.

HENRY, EDWARD L.—111 E. 25th st., New York. Born in Charleston, South Carolina, 1841. Pupil of Paul Weber and French Schools. Academician of National Academy of Design, New York. Member of American Water Color Society, New York. Pictures in Corcoran Art Gallery, Washington, and other museums and clubs. Medals at New Orleans and Chicago Expositions. Mention Honorable Paris.

190. On the ferry boat—time about 1832.

191. "Oh! I'se tired."

HEUERMANN, MAGDA M.—1107 Auditorium Tower. Born in Galesburg, Illinois. Pupil of Henry F. Spread and H. F. C. Sammons, Chicago, and of S. Hollosey and Wilhelm Duerr, Munich. Medals and Diplomas from World's Exposition, New Orleans, 1885; North, Central and South American Exposition, 1886; and World's Columbian Exposition, Chicago, 1893.

192. Case of miniature portraits on ivory.

1. Dorothy. Lent by Miss D. Heuermann.
2. Mrs. Jeanette Smith Herrick. Lent by Mrs. J. S. McCauley.

HILL, ROSWELL S.—939 Eighth av., New York. Born in Lawrence, Kansas, 1861. Pupil of Académie Julian and École des Beaux-Arts, Paris.

193. An old fashioned girl. Pastel.

HILLS, LAURA COOMBS—320 Boylston st., Boston. Born in Newburyport, Massachusetts, 1859. Pupil of Miss Helen Knowlton, Boston, Art Students' League, New York, and Cowles School, Boston.

194. Case of miniature portraits on ivory.

1. Miss Hills.
2. Mr. Hills.
3. Mrs. Hills.
4. M. N.
5. Little boy.
6. Little girl.
7. Laura Stevens.

HIND, JAMES FISHER—31 Boyken st., Morristown, New Jersey. Member of American Water Color Society, New York.

195. The Dolomites—Tyrolese Alps.

196. Evening on the Nile.

HUNTINGTON, DWIGHT—509 Johnston Building, Cincinnati.

206. Devil's lake, Sioux country.

207. Training the puppy.

IHLEFELD, HENRY—25 Clinton pl., Mt. Vernon, New York. Born in New York, 1858. Pupil of Art Students' League, New York, and École des Beaux-Arts, Paris.

208. Temptation.

ISHAM, SAMUEL—58 W. Fifty-seventh st., New York.

209. The shore. Pastel.

JEFFERYS, CHARLES W.—Riverside av., Woodside, New Jersey. Born in England, 1869.

210. A day in June.

211. Willows in Spring.

212. A little orchard.

JONES, FRANCIS COATES—253 W. Forty-second st., New York. Born in Baltimore, 1857. Pupil of École des Beaux-Arts, Lefebvre and Boulanger, Paris.

213. A difficult letter.

JONES, HUGH BOLTON—253 W. Forty-second street, New York. Born in Baltimore, 1858.

214. The boat landing.

JORDAN, DAVID WILSON—510 Woodland Terrace, Philadelphia. Born in Harrisburg, Pennsylvania, 1859. Pupil of Pennsylvania Academy of the Fine Arts under C. Schuessle and Thomas Eakins. Member of Art Club, of Philadelphia, and Philadelphia Sketch Club.

215. October afternoon—near sunset. Pastel.

HIRST, CLAUDE RAGUET—96 Fifth av., New York.

197. A favorite poet.

198. A page of ancient history.

HORNING, BENJAMIN — Van Dyck Studios, Eighth av. and 53th st., New York. Pupil of École des Beaux-Arts and Académie Julian, Paris.

199. An old sea horse.

HOWE, J. THEODORE—835 Broadway, New York. Born in Boston, 1868. Pupil of National Academy of Design, New York.

200. Marine.

201. Along the shore.

202. A sketch.

HOWE, WILLIAM HENRY — Bronxville, New York. Born in Ravenna, Ohio, 1846. Pupil of Otto von Thoren and F. de Vuillefroy, Paris. Associate of National Academy of Design, New York, 1894, and member of Salmagundi Club and Artists' Fund Society, New York. Mention honorable at New Orleans, 1885; Paris Salon, 1886. Medal of the third class from Paris Salon, 1888; second from Paris Exposition Universelle, 1889. Hors Concours, Paris Salon, 1890. Temple gold medal, Philadelphia, 1890, grand gold medal, London, 1890; gold medal, Boston, 1890. Medal of World's Columbian Exposition, Chicago, 1893. Gold medal of Midwinter Exposition at San Francisco, 1894. Grand gold medal, Atlanta, 1895. Officier d'Académie, Paris, 1896. Paintings owned by Museum of Fine Arts, St. Louis, and Illinois Club, Chicago.

203. In the meadow, Westchester, New York.

HULBERT, MRS. K. ALLMOND—South Egremont, Massachusetts. Born in Sacramento Valley, California, 1860.

204. A gray afternoon.

HUNT, ELIZABETH K.—96 Fifth av., New York.

205. Between the lights. Pastel.

JOSEPHI, I. A.—391 Fifth av., New York.

216. A New Jersey market garden.

JOSEPHS, LEMUEL B. C.—210 E. 16th st., New York. Born in Buffalo, New York, 1857.

217. The hill path.

218. "Hither they speed in perpetual courses."

KAELIN, CHARLES S.—1306 Race st., Cincinnati. Born in Cincinnati, 1857. Pupil of Cincinnati Art School and Art Students' League, New York.

219. On Passaic River, New Jersey. Pastel.

220. Passing clouds on Passaic River. Pastel.

221. Darkness before rain, Passaic River. Pastel.

222. Along the coast of Staten Island. Pastel.

223. Old wreck, Staten Island. Pastel.

KENDALL, SERGEANT—124 E. 37th st., New York. Born at Spuyten-Duyvil-on-Hudson, New York, 1869. Pupil of Art Students' League, New York, and of École des Beaux-Arts, Académie Julian, and Luc-Olivier Merson, Paris. Mention Honorable, Paris Salon 1891. Medal at World's Columbian Exposition, Chicago, 1893. Lippincotts Prize, Pennsylvania Academy of the Fine Arts, 1893.

224. Elevated Railroad at night. Pastel.

225. From Clairmont Bluff, New York City.
Pastel.

KETCHAM, SUSAN M—Studio 1010 Carnegie Hall, New York. Born in Indianapolis. Member of Art Students' League and Woman's Art Club, New York.

226. Expectation—a sketch. Pastel.

227. Flora. Pastel.

228. Off the Jersey coast.

KIMBALL, SARAH STANIFORD—Salem, Massachusetts.

229. Mt. Desert.

KLOTS, ALFRED—156 W. 48th st., New York. Born in St. Germain, Paris, 1875. Pupil of Rhoda Holmes Nicholls and William J. Whittmore.

230. Pine forest interior.

KNOWLTON, MISS HELEN M.—23 Irvington st., Boston. Born in Littleton, Massachusetts. Pupil of William M. Hunt and Frank Duveneck.

231. Head of an Italian boy. Pastel.

KRUSEMAN VAN ELTEN—51 W. 10th st., New York. Born in Alkmaar, Holland, 1829. Pupil of Lieste, Haarlem, Holland; Academician of National Academy of Design, New York. Member of the Academies of Amsterdam and Rotterdam, Holland. Medals. Chevalier of the order of the Lion of the Netherlands.

232. Cornfield.

233. Autumn.

234. Early Summer.

LAMPERT, EMMA E.—817 Powers Block, Rochester, New York. Studied in New York, Paris and Holland. Instructor in Painting, Mechanics' Institute, Rochester. Member of New York Water Color Club and of Woman's Art Association, Canada. Medal and Diploma for water colors from World's Columbia Exposition, Chicago, 1893. Honorable Mention for oil paintings, Atlanta Exposition, 1895.

235. The life work.

236. Hackling flax.

LATHROP, CLARA W.—Northampton, Massachusetts. Pupil of Bouguereau, Rolshoven and Tryon.

237. At St. Mark's. Pastel.

LEAVITT, AGNES—159A Tremont st., Boston. Born in Boston, 1859. Pupil of J. J. Enneking, M. H. Hardwick and Henry Sandham, Boston, and of Henry F. Spread, Chicago. Member of Boston Art Students' Association.

238. Mt. Moriah, Fairlee, Vermont, looking south through Crawford Notch, New Hampshire.

LINSON, CORWIN KNAPP—The Van Dyck, Eighth av. and 56th st., New York.

239. Straying.
240. In winter time.
241. Spring.

LIPPINCOTT, MARGARETTE—1334 Chestnut st., Philadelphia. Born in Philadelphia, 1862. Studied in Pennsylvania Academy of the Fine Arts, Philadelphia, and in Art Students' League, New York. Instructor in Water Colors in Philadelphia School of Design for Women. Member of New York Water Color Club.

242. Iridescent glass and roses.
243. Gloire de Rosamond roses.
244. Water lilies.
245. Violets and Snapdragon.

LORD, CAROLINE AUGUSTA—Hauck Building, McMillan st., Cincinnati. Born in Cincinnati, 1860. Pupil of Cincinnati Art Academy, Art Students' League, New York, and Académie Julian, Paris. Instructor in Cincinnati Art Academy.

246. The reader.

LOW, MRS. BERTHA LEA—1821 Pine st., Philadelphia. Born in Philadelphia. Pupil of Pennsylvania Academy of the Fine Arts.

247. Blue Mountains in Autumn.

LUCE, MRS. MARIA HUXFORD—Auburn, New York. Born in Skaneateles, New York, 1843. Pupil of Mrs. Clara Good-year, New York, of Delécluse Academy in Paris, two months, and of J. S. H. Kever in Holland, four months.

248. Still life.

249. Apples.

LUNGREN, FERNAND—The Van Dyck, 939 Eighth av., New York.

250. Thirst: The beginning of the end.

251. Looking for camp.

252. At fault.

253. On day herd.

254. The Painted Desert.

255. On the range, looking up stock.

256. Cimeroon.

257. A princess of Tusayan.

258. Navajo trailer.

259. Trail on the high place. Pastel.

260. Silence. Pastel.

261. From a bridge. Pastel.

262. In the lava. Pastel.

263. Moonlight. Pastel.

LUSK, MARIE K.—529 E. Forty-seventh st. Born in Bohemia, 1862. Studied in Chicago, New York and Paris.

264. Sweet reminders of spring.

265. Lost in wonderland.

MAGILL, BEATRICE—Swarthmore, Pennsylvania. Born in Providence, Massachusetts. Pupil of Pennsylvania Academy of the Fine Arts, Philadelphia, William Sartain, and, in Paris, of Feyen-Perrin.

266. Mending nets, Venice.

MANN, EMILY PERCY—Grundmann Studios, Clarendon st., Boston.

267. Rocks and surf, coast of Maine.

268. Chrysanthemum panel.

MARBLE, JOHN NELSON—253 W. 42d st., New York. Born in Woodstock, Vermont, 1855. Pupil of William M. Hunt, Bouguereau and Robert-Fleury.

269. The mower.

McCHESNEY, CLARA T.—37 W. 22d st., New York. Born in California, 1861. Pupil of San Francisco Art School and of Gotham Art School, New York. Water color owned by Boston Art Club. Norman Dodge Prize at National Academy of Design, New York, 1894.

270. The gleaner.

MCCORD, WILLIAM ALEXANDER—Carew Building, Cincinnati, Ohio.

271. A seaside nocturne. Pastel.

272. Low tide.

273. The path by the lake.

274. Lost.

MCDOWELL, EDWARD G.—36 W. Baltimore st., Baltimore. Born in Baltimore.

275. An orchard in Spring.

276. The pond.

McILHENNY, C. MORGAN—Shrub Oak, New York.

277. Early Spring.

MEAKIN, LEWIS HENRY — Cincinnati Art Museum, Cincinnati. Born in England. Pupil of Loefftz and Gysis in Munich, and of Courtois in Paris. Instructor in Art Academy of Cincinnati.

278. Chioggia fishing boats.

279. Afternoon on the lagoon.

MENTE, CHARLES—24 E. 4th st., New York.

280. The potato harvest.

METHVEN, HARRY WALLACE—3835 Ellis av. Born in Philadelphia. Instructor in Drawing and Painting at Kemper Hall, Kenosha, and at Beloit College. Officer of Cosmopolitan Art Club and Society of Western Artists, Chicago.

281. Blue and silver—a March afternoon.

MILLS, J. HARRISON—18 E. 23d st., New York. Born in Buffalo, New York, 1842.

282. A South wind.

MORAN, LÉON—126 E. 24th st., New York. Born in Philadelphia, 1864. Pupil of Edward Moran and National Academy of Design, New York. Gold Medal of Art Club of Philadelphia.

283. Day dreams.

MORSE, EDWARD LIND—116 Ravine av., Yonkers, New York. Born in Poughkeepsie, New York, 1857. Pupil of Carl Gussow and the Royal Academy, Berlin; of Max Thedy, Weimar, and of Boulanger and Ferrier, Paris.

284. The boy and the skull. Pastel.

285. Jack and Clara. Pastel.

MOSS, CHARLES EUGENE—116 W. 41st st., New York. Born in Ohio, 1869. Studied in Paris. Member of New York Water Color Club.

286. The pasture.

287. Fireside reveries.

MUHRMAN, HENRY—Hampstead, London, care Geo. H. Rapp, 198 E. 44th st., Chicago. Born in Cincinnati, 1854. Pupil of Munich Academy. Medal at World's Columbian Exposition, Chicago, 1893.

288. Vale of Health, Hampstead. Pastel.

289. Hampstead Heath. Pastel.

290. View on West Heath, Hampstead. Pastel.

MURPHY, J. FRANCIS—The Chelsea, 222 W. 23d st., New York. Born in Oswego, New York, 1853.

291. Spring showers.

292. Rainy day.

293. Foggy morning.

MURPHY, MRS. J. FRANCIS—222 W. 23d st., New York. Third Hallgarten Prize, National Academy of Design, New York.

294. Gathering blossoms.

MYGATT, ROBERTSON K.—1425 Broadway, New York.

295. Early spring, Connecticut.

NEEDHAM, CHARLES AUSTIN—145 E. 23d st., New York.

296. A river bank.

NEWLIN, ARCHIE—1710 Chestnut st., Philadelphia. Born in Philadelphia. Pupil of Pennsylvania Museum School, and Pennsylvania Academy of the Fine Arts.

297. Diving rocks at Annisquam, Massachusetts.

NICOLL, JAMES CRAIG—51 W. 10th st., New York. Born in New York City, 1848. Pupil of M. F. H. de Haas. Secretary of National Academy of Design; Secretary of Artists' Aid Society; member of American Water Color Society, New York Etching Club, etc.

298. Autumnal moonlight.

NOWOTNY, VINCENT—Art Academy, Cincinnati. Born in Mt. Vernon, Ohio, 1853. Studied in Munich and Paris. Instructor in the Art Academy of Cincinnati.

299. Edge of the village. Pastel.

PALMER, WALTER LAUNT—5 LaFayette st., Albany, New York. Born in Albany, 1854. Son of Erastus Dow Palmer. Pupil of F. E. Church, Hudson, New York, and Carolus-Duran, Paris. Associate of National Academy of Design, New York. Member of Society of American Artists, American Water Color Society, New York Water Color Club and Pastel Club, New York. Second Hallgarten prize, \$200, at National Academy of Design, 1887; medal at World's Columbian Exposition, Chicago, 1893; gold medal, only award, of Art Club of Philadelphia, 1894; Evans prize of \$300, only award, American Water Color Society, New York, 1895; first prize, \$250, Boston Art Club, 1895.

300. A hillside.

301. Rio di San Giuseppe, Venice.

302. Moonlight on the grand canal, Venice.

303. A winter's night.

304. Two Venetian boats.

305. Moonrise at dusk.

306. Wall of the public gardens, Venice.

307. The Piazzetta at twilight, Venice.

PARRISH, CLARA WEAVER, 78 W. 54th st., New York.

308. Reverie.

PATTISON, JAMES WILLIAM—Jacksonville, Illinois. Born in Boston, 1844. Pupil of Prof. Flamm in Düsseldorf and Luigi Chiallva in Paris. First exhibited in the Salon in 1879. Member of Chicago Society of Artists. Director of School of Fine Arts, Jacksonville. Medal of Massachusetts Charitable Mechanic Association, 1881.

309. Barr Island, Pott's Harbor, Maine.

310. Tide Swamp, Haskell Island, Maine.

PAYEN, CECILE E.—100 Auditorium Building. Born in Dubuque, Iowa. Studied in New York and Paris. Medal at World's Columbian Exposition, Chicago, 1893.

311. Portrait of my mother. Miniature on ivory.

PETERS, GEORGE W.—Leonora, New Jersey. Born in Lebanon, Pennsylvania, 1866.

312. Winter.

313. Jersey hills in December.

PHILLIPS, BERT G.—15 W. 63rd st., New York. Born in Hudson, New York, 1868. Pupil of National Academy of Design and Art Students' League, New York, and of Benjamin-Constant and Jean-Paul Laurens, Paris.

314. Night scene in the street, Hawarden.

PITTS, FRED L.—201 S. 11th st., Philadelphia. Born in Maryland, 1842. Studied in Pennsylvania Academy of the Fine Arts, Philadelphia, and in the McMicken School, Cincinnati.

315. Evening at Somers Point.

POST, WILLIAM MERRITT—55 W. Thirty-third st., New York. Born in Brooklyn, 1857.

316. "The chilling breeze sweeps the dead leaves
from the trees."

POTTHAST, EDWARD HENRY—21 W. Twenty-Fourth st., New York. Born in Cincinnati. Pupil of Académie Julian and Cormon, Paris.

317. Scene in Bermuda.

318. Silent woods.

319. Hamilton, Bermuda.

REAUGH, FRANK—160 Eighth st., Oak Cliff, Texas.

320. In the woodlot. Pastel.

REDMOND, FRIEDA VOELTER—58 W. Fifty-seventh st., New York. Born in Thun, Switzerland.

321. Still life.

REDMOND, JOHN J.—58 W. Fifty-seventh st., New York. Born in Salem, Massachusetts. Pupil of Museum of Fine Arts, Boston.

322. Amsterdam.

323. View over the city of Bruges.

REHN, F. K. M.—The Chelsea, 222 W. 23d st., New York. Born in Philadelphia. Pupil of Pennsylvania Academy of the Fine Arts. First prize for marine painting, St. Louis, 1882. Prize of \$250 at Water Color Competitive Exhibition, New York, 1885. Gold medal at Prize Fund Exhibition, New York, 1886. Picture "The Missing Vessel," owned by Detroit Art Museum, "Close of a Summer Day," by the Buffalo Fine Arts Gallery.

324. Surf at North Asbury, New Jersey.

325. West Hampton, Long Island.

RETTIG, JOHN—20 College Building, Cincinnati. Born in Cincinnati, 1858. Graduate of Cincinnati School of Design (now Art Academy) and ex-President of the Cincinnati Art Club.

326. Shadows and reflections. Gouache.

RICHARDS, FREDERIC DE B.—1520 Chestnut, st., Philadelphia.

327. The homestead.

328. The salt marshes.

RICHARDS, WILLIAM T.—Newport. Born in Philadelphia, 1833. Honorary Member of National Academy of Design, New York. Member of American Water Color Society, New York. Pictures owned by Corcoran Gallery, Washington; Metropolitan Museum, New York; Pennsylvania Academy of the Fine Arts, Philadelphia and the Museum of Haarlem, Holland. Medal of Centennial Exposition, Philadelphia, 1876; Temple medal, Pennsylvania Academy of the Fine Arts, 1885; bronze medal Exposition Universelle, Paris, 1889.

329. Afternoon.

RICHARDSON, FRANK H.—9 rue des Fourneaux, Paris. Born in Boston, 1859. Pupil of Lefebvre and Boulanger, Académie Julian, Paris.

330. Approach to Montcourt.

ROBINSON, ALEXANDER CHARLES—Care of Artists' Packing and Shipping Co., 147 E. Twenty-third st., New York. Born in Portsmouth, New Hampshire, 1867. Pupil of Académie Julian, Paris. Member of New York Water Color Club.

331. Street fountain in Malaga, Spain.

ROBINSON, FLORENCE—Hotel Oxford, Boston. Born in Boston, 1868. Pupil of Harpignies, Paris.

332. Court of San Gregorio, Venice.

ROBINSON, THEODORE—Born in Irasburg, Vermont. Pupil of Carolus-Duran and J. L. Gérôme, Paris. Died in New York since the pictures named below were received for this exhibition.

333. Normandy mother and child.

334. Winter day in Vermont.

ROBINSON, WILL S.—Teachers' College, 120th st., New York.

335. Departure of fishing boats, coast of France.

336. At their moorings.

ROOSEVELT, S. M.—90 Pearl st., New York.
Born in New York, 1859. Pupil of Benjamin-Constant and Jean-Paul Laurens, Paris.

337. Portrait. Lent by Sanford Pomeroy, Paris.

ROSELAND, HARRY—191 Clinton st., Brooklyn, New York. Born in Brooklyn, 1865. J. F. Story Gold Medal at Brooklyn Art Club Exhibition, 1887.

338. Low tide toilers.

339. Unmasking.

SATTERLEE, WALTER—52 E. 23d st., New York. Born in New York.

340. The elder sister.

SCHELL, F. CRESSON—223 S. 6th st., Philadelphia. Born in Philadelphia, 1857. Pupil of Pennsylvania Academy of the Fine Arts

341. Abandoned.

SCHNEIDER, W. G.—69 Bank st., New York.

342. A young woman.

SCOTT, MRS. E. M.—142 E. 18th st., New York.
Studied in Art Students' League, New York, and in Paris. Recording Secretary of Water Color Club.

343. Roses.

344. Country roses.

SCOTT, WILLIAM WALLACE—I Madison av., New York. Born in Leicester, England, 1820. Pupil of Royal Academy, London.

345. Portrait of C. J. Lyon. Miniature on ivory.

SENAT, PROSPER L.—Wissahickon av., Germantown, Philadelphia. Born in Germantown, 1852. Studied in École des Beaux-Arts, Paris and in Antwerp and London. One painting in the Temple Collection of the Pennsylvania Academy of the Fine Arts, Philadelphia and one in the Metropolitan Museum of Art, New York.

346. The south cliffs of Capri.

347. Clearing weather, north shore of Bermuda.

348. A Sicilian hillside.

SHEPLEY, ANNIE BARROWS—96 Fifth av., New York. Pupil of H. Siddons Mowbray, Jules Lefebvre and Benjamin-Constant. Member of New York Water Color Club and Woman's Art Club of New York.

349. Poor Matilda.

350. The Holsäker Sunday dress, Dalecarlia, Sweden.

351. Daffodil. Pastel.

352. Head of a girl. Pastel.

SHERWOOD, MRS. ROSINA EMMET—Neptune Island, New Rochelle, New York. Born in New York. Pupil of William M. Chase, New York, and Académie Julian, Paris. Silver medal of Exposition Universelle, Paris, 1889; medal of World's Columbian Exposition, Chicago, 1893.

353. Nymph of Hymen. Pastel.

354. The portrait.

355. Study. Pastel.

SHOREY, GEORGE H.—140 W. 23d st., New York City. Born at Hoosick Falls, New York. Pupil of Artist-Artisan's Institute, John Ward Stimson and Walter Shirlaw, New York. Teacher in Artist-Artisan's Institute.

356. Mermaid teasing a fish.

357. October clouds.

SHURTLEFF, R. M.—44 W. 22d st., New York. Born in Rindge, New Hampshire. Academician of National Academy of Design, New York. Member of American Water Color Society, New York.

358. Morning mists from the mountains.

359. Edge of the woods.

SLAFTER, THEODORE SHOREY—Dedham, Massachusetts. Pupil of Royal Academy, Munich.

360. Under the pine tree.

SLOANE, GEORGE—110 Tremont st., Boston.

361. Case of miniatures. Five portraits of ladies.

SMEDLEY, WILLIAM T.—The Chelsea, 222 W. 23d st., New York. Born in Pennsylvania. Member of American Water Color Society and Society of American Artists, New York.

362. The end of the season.

363. Uncle Remus.

SMILLIE GEORGE H.—51 E. 59th st., New York. Born in New York City. Studied with James M. Hart, New York, and painted in France. Academician of National Academy of Design, New York, and Member of American Water Color Society, New York. First prize at American Art Association Water Color Exhibition, New York, 1885.

364. Bald Porcupine, Bar Harbor, Maine.

SMITH, HOLMES—Washington University, St. Louis. Born in Keighley, Yorkshire, England, 1863.

365. Morning in Whitby Harbor.

SMITH, LETTA CRAPO—789 Jefferson st., Detroit.
Born in Detroit. Pupil of Julius Rolshoven in Paris,

366. In St. Marks. Pastel.

367. Italian girl. Pastel.

SMITH, OLIVER PHELPS—1177 Bushwick av.,
Brooklyn. Born in Hartford, Connecticut, 1867.

368. Dryad.

SMITH, W. GRANVILLE—See Granville-Smith.

SNELL, HENRY B.—116 W. 41st st., New York.
Secretary of New York Water Color Club.

369. Lifting fog at sunset.

370. Safe in port.

371. Murray Bay, on the St. Lawrence River.

SONNTAG, WILLIAM LOUIS—120 E. 22nd st.,
New York. Born in Pittsburgh, Pennsylvania, 1822. Academician of
National Academy of Design, New York. Member of American Water
Color Society and Artists' Fund Society, New York.

372. Deepening shadows.

373. Tanglewood.

SONNTAG, WILLIAM LOUIS, JR.—Y. M. C. A.
Building, 52 E. 23d st., New York. Born in New York City, 1869.

374. Coup de grâce.

STANGE, EMILE—605 Union Place, West Ho-
boken, New Jersey. Born in Jersey City, New Jersey, 1863.

375. In Pennsylvania.

STARK, OTTO—84 E. Market st., Indianapolis, Indiana. Born in Indianapolis, 1859. Pupil of Art Students' League New York, and of Académie Julian and F. Cormon, Paris.

376. The telegram.

377. Character head.

378. The old horse.

378½. Autumn leaves.

STROUD, LAURA D.—1710 Chestnut st., Philadelphia. Born in Philadelphia, 1863. Pupil of Pennsylvania Academy of the Fine Arts.

379. Chrysanthemums.

STUART, FREDERICK T.—42 Court st., Boston. Member of Boston Art Club and Boston Society of Water Color Painters. Picture in collection of Boston Art Club.

380. A back yard at Annisquam.

381. On the Charles River.

SVENDSEN, CHARLES C.—20 E. Court st., Cincinnati.

382. A modern Nestor.

SWORD, JAMES B.—1520 Chestnut st., Philadelphia. Born in Philadelphia, 1839. Pupil of Pennsylvania Academy of the Fine Arts, and W. T. Richards.

383. Little Harbor, Newcastle, New Hampshire.

SYKES, ANNIE G.—3018 Woodburn av., Walnut Hills, Cincinnati. Born in Brookline, Massachusetts. Pupil of Museum of Fine Arts, Boston, Cincinnati Art School and Frank Duveneck.

384. In the greenhouse.

TEWKSBURY, FANNY WALLACE—Newtonville, Massachusetts. Born in Boston. Member of New York Water Color Club.

385. Roses.

386. A field of golden rod.

387. White roses.

THOMAS, ELIZABETH H.—1020 Chestnut st., Philadelphia. Born in Philadelphia. Studied in Pennsylvania Academy of the Fine Arts and in Paris.

388. A library corner. Pastel.

THOMSON, HENRY GRINNELL—Wilton, Fairfield County, Connecticut. Born in New York.

389. Twilight.

390. On the hill top. Pastel.

TINKHAM, ALICE SPENCER—16 Grundmann Studios, Boston. Born in Boston. Pupil of Museum of Fine Arts School.

391. November.

TOWNSEND, FRANCES B.—82 Beacon st., Boston. Born in Boston. Pupil of Museum of Fine Arts and Cowles art schools, Boston, and of Julien Dupré, Paris. Gold medal of Atlanta Exposition, and silver medal of Massachusetts Charitable Mechanic Association Exhibition, Boston, 1895.

392. Head of a smooth-coated St. Bernard dog.

393. Interior of cathedral library, Siena.

394. A study of bric-a-brac.

TRISCOTT, S. P. ROLT—3 Winter st., Boston.

395. In the woods.

TRUMP, REBECCA N. VAN—1520 Chestnut st., Philadelphia. Born in Pennsylvania. Pupil of Pennsylvania Academy of the Fine Arts, Philadelphia and of Académie Julian, Paris.

396. A light corner.

TURNER, ROSS—Salem, Massachusetts. Born in Westport, Essex County, New York, 1847. Instructor in Massachusetts Institute of Technology, Boston.

397. The sea rover.

398. The hillside.

VAN DER VEER, MARY—96 Fifth av., New York. Born in Amsterdam, New York.

399. Old Mammy.

VAN DEUSEN, ALLEN W.—116 W. 41st st., New York. Studied in Académie Julian, Paris.

400. A foggy morning.

VAN DER WEYDEN—See Weyden.

VAN ELTEN—See Kruseman.

VAN LAER, ALEXANDER T.—58 W. 57th st., New York. Born in Auburn, N.Y., 1857. Pupil of R. Swain Gifford.

401. Evening.

VAN TRUMP—See Trump.

WADE, CAROLINE D.—728 Athenæum Building. Born in Chicago.

402. Fish houses at Monhegan, Maine.

WADSWORTH, FRANK R.—577 E. Division st.
Pupil of Art Institute, Chicago, and William M. Chase, New York.

403. The way to the stable.

404. Street in Pawtucket, Rhode Island.

405. In a New England town.

WAGNER, JACOB—Harcourt Building, Irvington
st., Boston. Born in Bavaria, Germany, 1855. Self taught.

406. The rose. Pastel.

407. Summer. Pastel.

WAITE, ALICE L.—737 Ontario st., Toledo, Ohio.
Born in Toledo. Pupil of Irving R. Wiles and Art Students' League,
New York. Member of Central Art Association of America.

408. In the orchard.

WALKER, CHARLES A.—20 Beacon st., Boston.
Born in Loudon, New Hampshire, 1848. Member of Boston Art Club and
World's Columbian Exposition Jury. Honorable Mention, Boston Art
Club's Fifty-Second Exhibition. Listed in London Printsellers Association.

409. A day in spring.

WATSON, ELIZABETH H.—126 S. 18th st., Phila-
delphia. Mary Smith Prize, Pennsylvania Academy of the Fine Arts,
1895-6.

410. Fish wharves, Gloucester, Massachusetts.
Pastel.

WEEK, CORA A.—Studio Building, State and
Ohio sts. Born in Wisconsin. Pupil of Kenyon Cox, Luc-Olivier Merson,
Raphael Collin and Aman-Jean.

411. Study in gray. Pastel.

WESTON, JAMES LOUIS—106 E. 23d st., New
York. Born in Toronto, Canada, 1864. Pupil of Montreal Art Associa-
tion, National Academy of Design, New York, and Metropolitan Museum
of Art, New York.

412. Reflections.

WEYDEN, HARRY VANDER—31 Avenued'Eylau, Paris. Born in Boston. Pupil of Jean-Paul Laurens, Paris. Medal of third class, Paris Salon.

413. On the bridge.

WHEELER, JANET—1710 Chestnut st., Philadelphia. Born in Detroit, Michigan. Pupil of Bouguereau, Robert-Fleury and Courtois, Paris. Charles Toppin Prize, Pennsylvania Academy of the Fine Arts.

414. The letter. Pastel.

415. A little Pandora. Pastel.

WHITE, HENRY C.—69 Gillett st., Hartford, Connecticut. Born in Hartford, 1861. Pupil of D. W. Tryon and Art Students' League, New York. Director of Art Department of Hartford High School.

416. April. Pastel.

417. A summer afternoon. Pastel.

418. Along the beach. Pastel.

419. Breakers. Pastel.

420. A breezy day. Pastel.

WHITESIDE, FRANK REED—Lansdowne, Delaware County, Pennsylvania. Born in Philadelphia, 1860.

421. A Zuni rabbit hunt.

WHITTEMORE, WILLIAM J.—253 W. 42nd st., New York.

422. Still life.

423. Still life.

424. Springtime.

425. Kynance Moors, Cornwall.

WHITTREDGE, WORTHINGTON — Summitt, New Jersey. Academician of National Academy of Design, New York.

426. Laurel blossoms.

WIGAND, O. C.—8 E. 17th st., New York. Born in New York. Pupil of Art Students' League, New York, and of Boulanger and Lefebvre, Paris.

427. Spring in Brittany.

WILCOX, BEATRICE C.—5101 Kimbark av.

428. Azaleas from Mobile.

WILLIAMS, FREDERICK B.—New York. Born in Brooklyn, 1871. Member of New York Water Color Club.

429. Meadow land.

430. A pastoral.

431. Woman and cow—before a rain.

432. A nymph. Pastel.

WILMOT, ALTA E.—7 Tree Studio Building, State and Ohio sts. Born in Ann Arbor, Michigan. Pupil of Art Students' League, New York, and the Julian and Colorossi Schools, Paris

433. Devonshire dairy court.

WILSON, HENRIETTA—2921 Monfort st., Walnut Hills, Cincinnati. Born in Cincinnati, 1855. Pupil of Cincinnati Art Academy and Frank Duveneck. Instructor in Cincinnati Art Academy.

434. Portrait. Pastel.

435. Study head. Pastel.

WITT, J. H.—1155 Broadway, New York.

436. Devotion.

WOOD, LOUISE—1710 Chestnut st., Philadelphia.
Born in Philadelphia. Pupil of Pennsylvania Academy of the Fine Arts, there; and of Académie Julian in Paris.

437. Portrait sketch. Pastel.

WOODBURY, CHARLES H.—192 Boylston st., Boston.

438. Hedgerows.

WOODBURY, MARCIA OAKES—192 Boylston st., Boston.

439. The smoker.

WOODBURY, EMMA A.—2017 Lexington av.
Born in Springfield, Vermont. Pupil of George Frost, Cambridge, Massachusetts.

440. Case of miniatures on ivory.

1. Mrs. M.
2. Polish lady.
3. Dr. Barrows.
4. Miss L.

WORES, THEODORE—Carnegie Hall Studios, 56th st. and Seventh av., New York City. Born in San Francisco, 1859.

441. Under the Wistaria, Kameido, Tokio, Japan.

YOUNG, CHARLES MORRIS—Gettysburg, Pennsylvania. Born in Gettysburg, 1869. Pupil of Pennsylvania Academy of the Fine Arts, Philadelphia. Honorable Mention and Charles Toppan Prize from said Academy.

442. Snow.

443. The stream. Pastel.

444. The snow storm. Pastel.

YOUNG, MISS GRACE—Care of Rookwood Pottery, Cincinnati.

445. Water carrier.

446. Study of a girl.

ZOGBAUM, RUFUS FAIRCHILD—New Rochelle, New York.

447. Boots and saddles.

SUMMARY OF ARTISTS.

The whole number of artists represented in the foregoing catalogue is 249—men, 166, women, 83.

The left hand column of figures in the following table groups the artists according to present residence; the right hand column according to place of birth.

	California	5	1	Texas	
3	Connecticut	5	1	Vermont	5
1	Delaware			Wisconsin	1
23	Illinois	8			<hr/> 168
2	Indiana	4	243		
	Iowa	2			
	Kansas	1		Bohemia	1
1	Maryland	4		Canada	2
	Maine	2	1	England	8
35	Massachusetts	27	2	France	2
1	Michigan	4		Germany	1
3	Missouri			Holland	1
	New Hampshire	5		Italy	
9	New Jersey	4	1	Norway	1
111	New York	42		Switzerland	1
19	Ohio	20			
31	Pennsylvania	27	2	Residence not given	
2	Rhode Island	1		Birthplace not given	64
	South Carolina	1	<hr/> 249		<hr/> 249